

LEED TOUR

Taylor Hall

1. LANDSCAPING & TRANSPORTATION: Innovative landscaping and native plant selection have reduced stormwater runoff at this site by more than 25% by absorbing rainwater. More than 50% of the plants used in the surrounding landscape are native to Virginia and help reduce Mason's water and maintenance requirements. Mason also provides alternative transportation infrastructure, including bike racks, to encourage carbon-free transportation to our campuses and facilities.

2. BUILDING MATERIALS: I.) More than 20% of all materials used to construct this building were manufactured and purchased within 500 miles of the building, reducing the GHG emissions from shipping materials far away, as well as other transportation costs. II.) More than 50% of the lumber used was harvested from sustainable managed forests. III.) Non-toxic paints, adhesives, and flooring were used in to enhance indoor air quality and the well-being of all occupants.

3. WATER EFFICIENCY: This building has reduced water consumption by more than 35% compared to a typical housing facility due to the use of water saving fixtures, such as low-flow toilets. Patriots can further reduce water consumption by taking shorter showers, turning off faucets when not in use, and reporting any dripping faucets immediately.

4. RECYCLING: More than 10% of the material used in the construction of this building came from recycled materials. This reduces the demand for harvesting new materials and promotes recycling and repurposing of used materials. Mason has provided a building-wide system for Patriots to recycle all paper, plastic, aluminum, glass, and cardboard.

5. ENERGY: In an effort to maximize Patriots' connection to the outdoors and reduce the cost of lighting, more than 75% of the occupied areas have a window view to the outdoors. In order to reduce Mason's energy usage and carbon footprint, this building uses 16% less energy than the average building due to a high-efficiency heating and air conditioning system, energy efficient appliances, use of natural sunlight, and LED lighting.

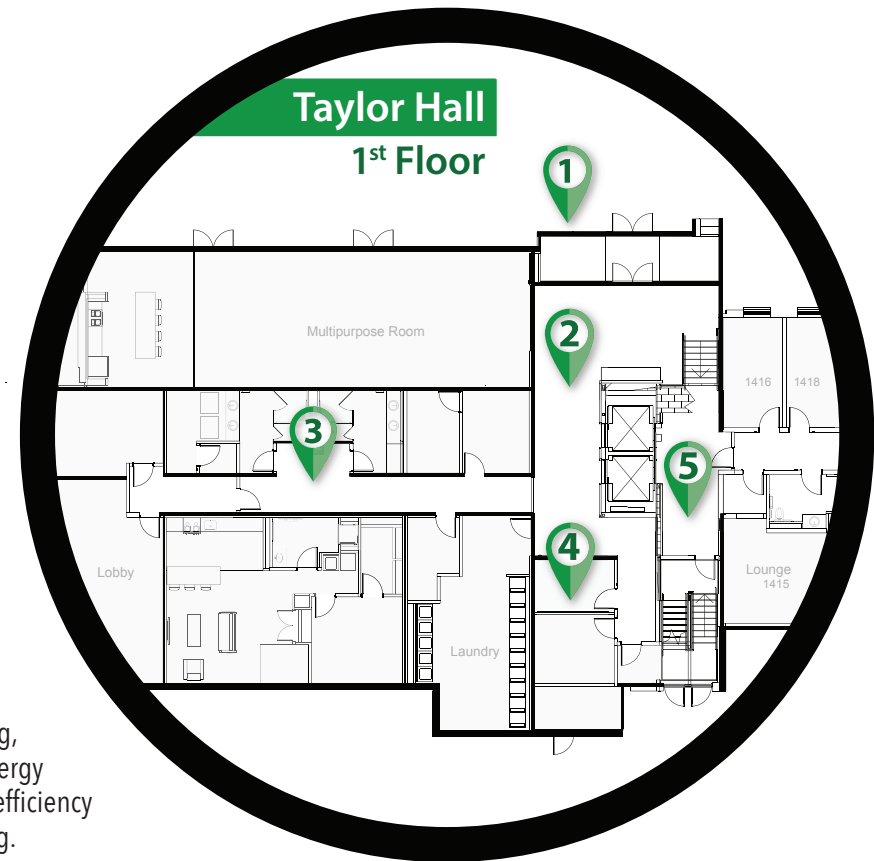

For more information about sustainability at Mason, please visit GREEN.GMU.EDU